

# Dissolved Oxygen Probe

(Order Code NavDOA)

The Forston Labs Dissolved Oxygen Probe is a Polarographic sensor and is sometimes referred to as a Clark Electrode. The Dissolved Oxygen Probe can be used to measure the concentration of dissolved oxygen in water samples tested in the field or in the laboratory.

## Inventory of Items Included with the Dissolved Oxygen Probe

Check to be sure that each of these items is included in your Dissolved Oxygen Probe box:

- Dissolved Oxygen Probe (dissolved oxygen electrode with membrane cap)
- One replacement membrane cap
- Sodium Sulfite Calibration Standard (2.0 M  $\text{Na}_2\text{SO}_3$ ) and MSDS sheet
- D.O. Electrode Filling Solution, MSDS sheet, and filling pipet
- Calibration bottle (empty, lid with hole)
- D.O. Polishing Strips (1 pkg)
- Dissolved Oxygen Probe booklet

## Do I Need to Calibrate the Dissolved Oxygen Probe?

It is not always necessary to perform a new calibration when using the Dissolved Oxygen Probe. If your experiment or application is looking only at a change in dissolved oxygen, then the software's stored calibration is all you need. If you are making discrete measurements, such as taking readings in a stream or lake, and you want to improve the accuracy of your measurements, then it is best to perform a new calibration.

## Preparing the Dissolved Oxygen Probe for Use

### Part A: Probe Preparation

1. Prepare the Dissolved Oxygen Probe for use.
  - a. Remove the blue protective cap from the tip of the probe. This protective cap can be discarded once the probe is unpacked.
  - b. Unscrew the membrane cap from the tip of the probe.

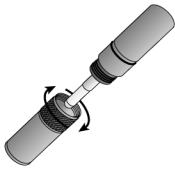

Remove  
membrane cap



Add electrode filling  
solution

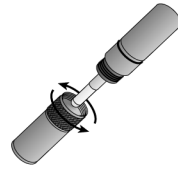

Replace  
membrane cap

- c. Using a pipette, fill the membrane cap with 1 mL of DO Electrode Filling Solution.
- d. Carefully thread the membrane cap back onto the electrode.
- e. Place the probe into a beaker filled with about 100 mL of distilled water.

### Part B: Probe Warm-up

2. Connect the Dissolved Oxygen Probe to the LabNavigator™.
3. It is necessary to warm up the Dissolved Oxygen Probe for 10 minutes before taking readings. To warm up the probe, leave it in the water and connected to the interface with the data collection program running for 10 minutes. The probe must stay connected at all times to keep it warmed up. If disconnected for a few minutes, it will be necessary to warm up the probe again.

### Part C: Probe Calibration

4. You are now ready to choose the calibration method for the Dissolved Oxygen Probe.

- If you wish to use the stored calibration, proceed to Part D.
- If you wish to perform a new calibration for the Dissolved Oxygen Probe, follow this procedure:

- a. Tap on the Meter Screen and then tap Calibrate. The Calibration Screen provides step-by-step instructions for calibration.
- b. **First Calibration Point:** Remove the probe from the water and place the tip of the probe into the Sodium Sulfite Calibration Solution.
- c. When the displayed voltage reading stabilizes, enter **0** (the known dissolved oxygen value in mg/L).
- d. **Second Calibration Point:** Rinse the probe with distilled water and gently blot dry.
- e. Unscrew the lid of the calibration bottle provided with the probe. Slide

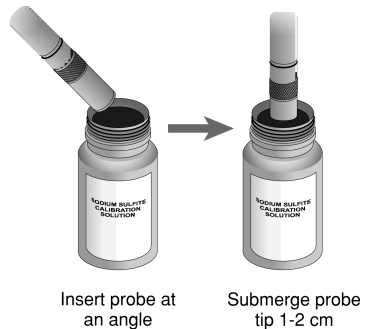

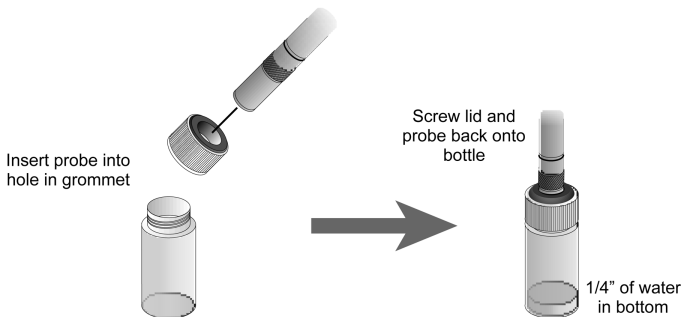

the lid and the grommet about  $\frac{1}{2}$  inch onto the probe body.

- f. Add water to the bottle to a depth of about  $\frac{1}{4}$  inch and screw the bottle into the cap, as shown. **Important:** Do not touch the membrane or get it wet during this step. Keep the probe in this position for about a minute.
- g. When the displayed voltage reading stabilizes, enter the correct saturated dissolved oxygen value (in mg/L) from Table 1 using the current barometric pressure and air temperature values. If you do not have the current air pressure, use Table 2 to estimate the air pressure at your altitude.

## Part D: Collecting Data

5. You are now ready to collect dissolved oxygen concentration data.
  - a. Place the tip of the probe into the water being tested (submerge 4–6 cm). Do not completely submerge. The handle is not waterproof.
  - b. Gently stir the probe in the water sample. Monitor the dissolved oxygen concentration in the live readouts. **Note:** It is important to keep stirring the probe in the water sample. There must always be water flowing past the probe tip when you are taking measurements. As the probe measures the concentration of dissolved oxygen, it removes oxygen from the water at the junction of the probe membrane. If the probe is left still in calm water, reported DO readings will appear to be dropping.

## Specifications

Range:	0 to 15 mg/L (or ppm)
Accuracy:	$\pm 0.2$ mg/L
Resolution	0.014 mg/L
Response Time:	95% of final reading in 30 seconds, 98% in 45 seconds
Temperature Compensation:	automatic from 5–35°C
Pressure Compensation:	manual, accounted for during calibration
Salinity Compensation:	manual, accounted for during calibration
Minimum sample flow:	20 cm/second

Stored Calibration Values

Slope = 3.27  
 Intercept = -0.327

This sensor is equipped with circuitry that supports auto-ID.

**Table 1: Dissolved oxygen (mg/L) in air-saturated distilled water  
 (at various temperature and pressure values)**

	770 mm	760 mm	750 mm	740 mm	730 mm	720 mm	710 mm	700 mm
0°C	14.76	14.57	14.38	14.19	13.99	13.80	13.61	13.42
1°C	14.38	14.19	14.00	13.82	13.63	13.44	13.26	13.07
2°C	14.01	13.82	13.64	13.46	13.28	13.10	12.92	12.73
3°C	13.65	13.47	13.29	13.12	12.94	12.76	12.59	12.41
4°C	13.31	13.13	12.96	12.79	12.61	12.44	12.27	12.10
5°C	12.97	12.81	12.64	12.47	12.30	12.13	11.96	11.80
6°C	12.66	12.49	12.33	12.16	12.00	11.83	11.67	11.51
7°C	12.35	12.19	12.03	11.87	11.71	11.55	11.39	11.23
8°C	12.05	11.90	11.74	11.58	11.43	11.27	11.11	10.96
9°C	11.77	11.62	11.46	11.31	11.16	11.01	10.85	10.70
10°C	11.50	11.35	11.20	11.05	10.90	10.75	10.60	10.45
11°C	11.24	11.09	10.94	10.80	10.65	10.51	10.36	10.21
12°C	10.98	10.84	10.70	10.56	10.41	10.27	10.13	9.99
13°C	10.74	10.60	10.46	10.32	10.18	10.04	9.90	9.77
14°C	10.51	10.37	10.24	10.10	9.96	9.83	9.69	9.55
15°C	10.29	10.15	10.02	9.88	9.75	9.62	9.48	9.35
16°C	10.07	9.94	9.81	9.68	9.55	9.42	9.29	9.15
17°C	9.86	9.74	9.61	9.48	9.35	9.22	9.10	8.97
18°C	9.67	9.54	9.41	9.29	9.16	9.04	8.91	8.79
19°C	9.47	9.35	9.23	9.11	8.98	8.86	8.74	8.61
20°C	9.29	9.17	9.05	8.93	8.81	8.69	8.57	8.45
21°C	9.11	9.00	8.88	8.76	8.64	8.52	8.40	8.28
22°C	8.94	8.83	8.71	8.59	8.48	8.36	8.25	8.13
23°C	8.78	8.66	8.55	8.44	8.32	8.21	8.09	7.98
24°C	8.62	8.51	8.40	8.28	8.17	8.06	7.95	7.84
25°C	8.47	8.36	8.25	8.14	8.03	7.92	7.81	7.70

26°C	8.32	8.21	8.10	7.99	7.89	7.78	7.67	7.56
27°C	8.17	8.07	7.96	7.86	7.75	7.64	7.54	7.43
28°C	8.04	7.93	7.83	7.72	7.62	7.51	7.41	7.30
29°C	7.90	7.80	7.69	7.59	7.49	7.39	7.28	7.18
30°C	7.77	7.67	7.57	7.47	7.36	7.26	7.16	7.06
31°C	7.64	7.54	7.44	7.34	7.24	7.14	7.04	6.94
32°C	7.51	7.42	7.32	7.22	7.12	7.03	6.93	6.83
33°C	7.39	7.29	7.20	7.10	7.01	6.91	6.81	6.72
34°C	7.27	7.17	7.08	6.98	6.89	6.80	6.70	6.61
35°C	7.15	7.05	6.96	6.87	6.78	6.68	6.59	6.50

**Table 1 (cont.) : Dissolved oxygen (mg/L) in  
air-saturated distilled water (at various temperature and pressure values)**

	690 mm	680 mm	670 mm	660 mm	650 mm
0°C	13.23	13.04	12.84	12.65	12.46
1°C	12.88	12.70	12.51	12.32	12.14
2°C	12.55	12.37	12.19	12.01	11.82
3°C	12.23	12.05	11.88	11.70	11.52
4°C	11.92	11.75	11.58	11.40	11.23
5°C	11.63	11.46	11.29	11.12	10.95
6°C	11.34	11.18	11.01	10.85	10.68
7°C	11.07	10.91	10.75	10.59	10.42
8°C	10.80	10.65	10.49	10.33	10.18
9°C	10.55	10.39	10.24	10.09	9.94
10°C	10.30	10.15	10.00	9.86	9.71
11°C	10.07	9.92	9.78	9.63	9.48
12°C	9.84	9.70	9.56	9.41	9.27
13°C	9.63	9.49	9.35	9.21	9.07
14°C	9.42	9.28	9.14	9.01	8.87
15°C	9.22	9.08	8.95	8.82	8.68
16°C	9.02	8.89	8.76	8.63	8.50
17°C	8.84	8.71	8.58	8.45	8.33
18°C	8.66	8.54	8.41	8.28	8.16
19°C	8.49	8.37	8.24	8.12	8.00
20°C	8.33	8.20	8.08	7.96	7.84
21°C	8.17	8.05	7.93	7.81	7.69
22°C	8.01	7.90	7.78	7.67	7.55
23°C	7.87	7.75	7.64	7.52	7.41
24°C	7.72	7.61	7.50	7.39	7.28
25°C	7.59	7.48	7.37	7.26	7.15
26°C	7.45	7.35	7.24	7.13	7.02
27°C	7.33	7.22	7.11	7.01	6.90

<b>28°C</b>	7.20	7.10	6.99	6.89	6.78
<b>29°C</b>	7.08	6.98	6.87	6.77	6.67
<b>30°C</b>	6.96	6.86	6.76	6.66	6.56
<b>31°C</b>	6.85	6.75	6.65	6.55	6.45
<b>32°C</b>	6.73	6.63	6.54	6.44	6.34
<b>33°C</b>	6.62	6.53	6.43	6.33	6.24
<b>34°C</b>	6.51	6.42	6.32	6.23	6.13
<b>35°C</b>	6.40	6.31	6.22	6.13	6.03

## Elevation Barometric Pressure Table

If you do not have a barometer available to read barometric pressure, you can estimate the barometric pressure reading at your elevation (in feet) from Table 2. The values are calculated based on a barometric air pressure reading of 760 mm Hg at sea level.

**Table 2: Approximate Barometric Pressure at Different Elevations**

Elevation (feet)	Pressure (mm Hg)	Elevation (feet)	Pressure (mm Hg)	Elevation (feet)	Pressure (mm Hg)
0	760	2000	708	4000	659
250	753	2250	702	4250	653
500	746	2500	695	4500	647
750	739	2750	689	4750	641
1000	733	3000	683	5000	635
1250	727	3250	677	5250	629
1500	720	3500	671	5500	624
1750	714	3750	665	5750	618

## How the Dissolved Oxygen Probe Works

The Forston Labs Dissolved Oxygen Probe is a Clark-type polarographic electrode that senses the oxygen concentration in water and aqueous solutions. A platinum cathode and a silver/silver chloride reference anode in KCl electrolyte are separated from the sample by a gas-permeable plastic membrane.

*Figure 1*

A fixed voltage is applied to the platinum electrode. As oxygen diffuses through the membrane to the cathode, it is reduced:

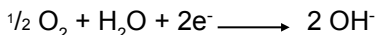

The oxidation taking place at the reference electrode (anode) is:

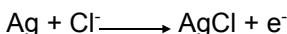

Accordingly, a current will flow that is proportional to the rate of diffusion of oxygen, and in turn to the concentration of dissolved oxygen in the sample. This current is converted to a proportional voltage, which is amplified and read by any of the LabNavigator.

## Storage and Maintenance of the Dissolved Oxygen Probe

Following the procedure outlined in this section will enhance the lifetime of your Dissolved Oxygen Probe and its membrane cap. Follow these steps when storing the electrode:

- **Long-term storage (more than 24 hours):** Remove the membrane cap and rinse the inside and outside of the cap with distilled water. Shake the membrane cap dry. Also rinse and dry the exposed anode and cathode inner elements (blot dry with a lab wipe). Reinstall the membrane cap loosely onto the electrode body for storage. Do not screw it on tightly.
- **Short-term storage (less than 24 hours):** Store the Dissolved Oxygen Probe with the membrane end submerged in about 1 inch of distilled water.
- **Polishing the metal electrodes:** If the cathode (the small, shiny, metal contact in the center of the glass stem shown in Figure 1) and anode (the silver, metal foil surrounding the lower portion of the inner body) become discolored or appear corroded, polish them with the polishing strip that is provided with the probe. Perform this operation only as needed to restore electrode performance—it should be necessary only once every year or so. Remove the membrane cap from your Forston Labs Dissolved Oxygen Probe. Thoroughly rinse the inner elements of the probe with distilled water to remove all filling solution. Cut a one-inch piece from the D.O. Electrode Polishing Strip provided. Wet the dull (abrasive) side of the polishing strip with distilled water. Using a circular motion, polish the center glass element of the cathode (on the very end of the electrode). Use gentle finger pressure during this polishing operation. Polish only enough to restore a bright, clean surface to the center element. Next, polish the silver anode located around the base of

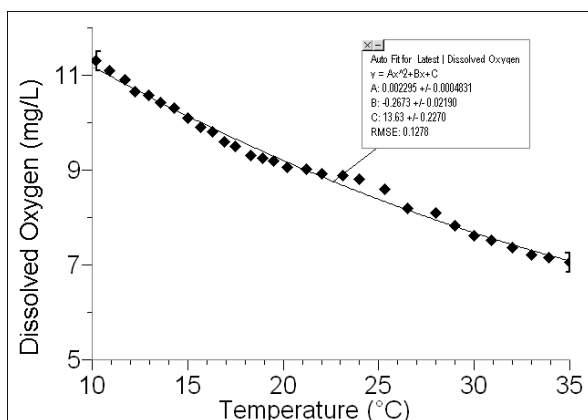

the electrode inner element. Polish only enough to restore a silver appearance. **Note:** Aggressive polishing will damage the probe inner

elements. *Be sure* to use only gentle pressure when performing the polishing of the anode and cathode. When you have completed the polishing, rinse the cathode and anode elements thoroughly and dry with a lab wipe.

With normal use, the Forston Labs Dissolved Oxygen Probe will last for years. The membrane cap will, however, require replacement after about 6 months of continuous use. Replacement of the membrane is recommended when your Dissolved Oxygen Probe will no longer respond rapidly during calibration or when taking D.O. readings. Use of your Dissolved Oxygen Probe in samples that are non-aqueous or in those that contain oil, grease, or other coating agents will result in shortened membrane life. Replacement membranes can be obtained from Forston Labs (order code NavDO-012A).

## Automatic Temperature Compensation

Your Forston Labs Dissolved Oxygen Probe is automatically temperature compensated, using a thermistor built into the probe. The temperature output of this probe is used to automatically compensate for changes in permeability of the membrane with changing temperature. If the probe was not temperature compensated, you would notice a change in the dissolved oxygen reading as temperature changed, even if the actual concentration of dissolved oxygen in the solution did not change. Here are two examples of how automatic temperature compensation works:

- If you calibrate the Dissolved Oxygen Probe in the lab at 25°C and 760 mm Hg barometric pressure (assume salinity is negligible), the value you enter for the saturated oxygen calibration point would be 8.36 mg/L (see Table 1). If you were to take a reading in distilled water that is saturated with oxygen by rapid stirring, you would get a reading of 8.36 mg/L. *If* the water sample were then cooled to 10°C with no additional stirring, the water would no longer be saturated (cold water can hold more dissolved oxygen than warm water). So, the reading of the temperature-compensated Dissolved Oxygen Probe would still be 8.36 mg/L.
- If, however, the solution was cooled to 10°C *and* continually stirred so it remained saturated by dissolving additional oxygen, the temperature-compensated probe would give a reading of 11.35 mg/L—the value shown in Figure 2. **Note:** Temperature compensation *does not mean* that the reading for a saturated solution will be the same at two different temperatures—the two solutions have different concentrations of dissolved oxygen, and the probe reading should reflect this difference.

*Figure 2: Saturated Dissolved Oxygen vs. Temperature Data*

## Sampling in Ocean Salt Water or Tidal Estuaries

### (at salinity levels greater than 1000 mg/L)

Dissolved Oxygen concentration for air saturated water at various salinity values,  $DO_{(salt)}$ , can be calculated using the formula:

$$DO_{(salt)} = DO - (k \cdot S)$$

- $DO_{(salt)}$  is the concentration of dissolved oxygen (in mg/L) in salt-water solutions.
- $DO$  is the dissolved oxygen concentration for air-saturated distilled water as determined from Table 1.
- $S$  is the salinity value (in ppt). Salinity values can be determined using the Forston Labs Chloride Ion-Selective Electrode or Conductivity Probe.
- $k$  is a constant. The value of  $k$  varies according to the sample temperature, and can be determined from Table 3.

**Table 3: Salinity Correction Constant Values**

Temp. (°C)	Constant, k	Temp. (°C)	Constant, k	Temp. (°C)	Constant, k	Temp. (°C)	Constant, k
1	0.08796	8	0.06916	15	0.05602	22	0.04754
2	0.08485	9	0.06697	16	0.05456	23	0.04662
3	0.08184	10	0.06478	17	0.05328	24	0.04580
4	0.07911	11	0.06286	18	0.05201	25	0.04498
5	0.07646	12	0.06104	19	0.05073	26	0.04425
6	0.07391	13	0.05931	20	0.04964	27	0.04361
7	0.07135	14	0.05757	21	0.04854	28	0.04296

**Example:** Determine the saturated DO calibration value at a temperature of 23°C and a pressure of 750 mm Hg, when the Dissolved Oxygen Probe is used in seawater with a salinity value of 35.0 ppt.

First, find the dissolved oxygen value in Table 1 ( $DO = 8.55$  mg/L). Then find  $k$  in Table 3 at 23°C ( $k = 0.04662$ ). Substitute these values, as well as the salinity value, into the previous equation:

$$DO_{(salt)} = DO - (k \cdot S) = 8.55 - (0.04662 \times 35.0) = 8.55 - 1.63 = 6.92 \text{ mg/L}$$

Use the value 6.92 mg/L when performing the saturated DO calibration point (water-saturated air), as described in Step 6. The Dissolved Oxygen Probe will now be calibrated to give correct DO readings in salt-water samples with a salinity of 35.0 ppt.

**Important:** For most dissolved oxygen testing, it is not necessary to compensate for salinity; for example, if the salinity value is 0.5 ppt, using 25°C and 760 mm Hg, the calculation for  $DO(s)$  would be:

$$DO_{(salt)} = DO - (k \cdot S) = 8.36 - (0.04498 \times 0.5) = 8.36 - 0.023 = 8.34 \text{ mg/L}$$

At salinity levels less than 1.0 ppt, neglecting this correction results in an

error of less than 0.2%.

## Maintaining and Replenishing the Sodium Sulfite Calibration Solution

Having an oxygen-free solution to perform a zero-oxygen calibration point is essential for accurate readings with your Dissolved Oxygen Probe. The Sodium Sulfite Calibration Solution that was included with your probe will last a long time, but not indefinitely. Here are some suggestions for maintaining and replacing this solution:

- After your first use of the solution for calibration, the solution will no longer be brim full (some overflow results when the probe is inserted into the solution). If you cap the solution with an air space above the probe, oxygen gas in the space will dissolve in the sodium sulfite solution—as a result, the solution may not be oxygen free. To prevent this from occurring, before putting on the lid, gently squeeze the bottle so the level of the solution is at the very top of the bottle neck; with the solution at this level, screw on the lid. The bottle will remain in this “collapsed” position. Using this procedure, the 2.0 M  $\text{Na}_2\text{SO}_3$  should remain oxygen free for a long period of time. If the calibration voltage reading displayed during the first calibration point is higher than in previous calibrations, it may be time to replace the solution, as described below.
- The 2.0 M sodium sulfite ( $\text{Na}_2\text{SO}_3$ ) solution can be prepared from solid sodium sulfite crystals: Add 25.0 g of solid anhydrous sodium sulfite crystals ( $\text{Na}_2\text{SO}_3$ ) to enough distilled water to yield a final volume of 100 mL of solution. The sodium sulfite crystals do not need to be reagent grade; laboratory grade will work fine. Prepare the solution 24 hours in advance of doing the calibration to ensure that all oxygen has been depleted. If solid sodium sulfite is not available, you may substitute either 2.0 M sodium hydrogen sulfite solution, (sodium bisulfite, 20.8 g of  $\text{NaHSO}_3$  per 100 mL of solution) or 2.0 M potassium nitrite (17.0 g of  $\text{KNO}_2$  per 100 mL of solution).

## Replacement Parts

### Forston Labs

Replacement Membrane Caps	NavDO-012A
Polishing Strips (pkg of 2)	NavDO-009A
D.O. Probe Filling Solution	NavDO125mLA
D.O. Probe Calibration Solution	NavDO-006A

## Using the Dissolved Oxygen Probe with Other Forston Labs Sensors

It is very important for you to know that the Dissolved Oxygen Probe will interact with some other Forston Labs sensors and probes, *if* they are placed in the same solution (in the same aquarium or beaker, for example), *and* they are connected to the same interface box (e.g., the same LabNavigator interface). This situation arises because the Dissolved Oxygen Probe outputs a signal in the solution, and this signal can affect the reading of another probe.

The following probes *cannot* be connected to the same interface as a Dissolved Oxygen Probe and placed in the same solution:

- Conductivity Probe
- pH Sensor
- Direct-Connect Temperature Probe
- Ion Selective Electrodes

If you wish to take simultaneous readings using any of the probe combinations listed above, here are some alternative methods:

- To take simultaneous dissolved oxygen and conductivity or dissolved oxygen and pH readings, you can connect the probes to two different interfaces. If the two probes in question are connected to separate interfaces, the two probes will read correctly in the same solution.
- The Forston Labs Stainless Steel Temperature Probe (also shipped with CBL 2) can be used alongside the Dissolved Oxygen Probe.
- If you are sampling a lake or stream and want to use two of the probes with a single interface, you can connect the two probes in question to the same LabNavigator™. Place one probe in the water first and take its reading. Then remove it and place the second probe in the solution to take its reading.

## Calibrating and Monitoring Using Units of Percent Saturation

Instead of calibrating using units of mg/L (equal to parts per million or ppm), you may also choose to calibrate dissolved oxygen using units of % saturation. When doing a calibration for units of % saturation, the calibration point done in the sodium sulfite solution (zero oxygen) is assigned a value of 0%, and that for water-saturated air (or air-saturated water) is given a value of 100%. It must be noted, however, that 100% represents an oxygen-saturated solution only at that particular temperature, pressure, and salinity level. If you intend to compare your measured dissolved oxygen values with data collected under a different set of conditions, a preferable method would be to use units of mg/L (described earlier in this booklet).

If you have calibrated your Dissolved Oxygen Probe in units of mg/L, you can easily calculate percent saturation using the formula:

$$\% \text{ saturation} = (\text{actual DO reading} / \text{Saturated DO reading from Table 1}) \times 100$$

For example, if your Dissolved Oxygen Probe gives a D.O. reading of 6.1 mg/L at a temperature of 20°C and a pressure of 740 mm Hg, look up the saturated dissolved oxygen reading in Table 1 (8.93 mg/L). The value for % saturation is:

$$\% \text{ saturation} = (6.1 / 8.93) \times 100 = 68\%$$

## Warranty

All Forston Labs Dissolved Oxygen Probes are warranted to be free from defects in material and workmanship for a period of one year from purchase of the probe, provided the electrode has been used in accordance with this instruction manual and used under normal laboratory conditions. The warranty does not apply when the electrode has been subjected to accident, alternate use, misuse, or abuse in any manner. Consumables, including the membrane, associated with Forston Labs products are excluded from this warranty.



# FORSTON LABS

Measure.Analyze.Record

**Forston Labs**

4098 Trouble Trail • Fort Collins, CO 80524

Toll Free (800) 301-1259 • (970) 237-4395 • FAX (970) 237-3347

info@forstonlabs.com • www.forstonlabs.com

Rev 2/01/10

LabNavigator, and other marks shown are our trademarks or registered trademarks in the United States.

All other marks not owned by us that appear herein are the property of their respective owners, who may or may not be affiliated with, connected to, or sponsored by us.

Printed on recycled paper.

